

Wervik, 1ste Afdeling

Sheet B

Trage weg Waterstraat
langsheen de fozzebek

Rooilijnplan:

Schaal: 1/500

Gelooft perceelen:

- Te bouwen weg (breedte 4 meter):
 - 100m x 4m = 400 m² (B360)
 - 200m x 4m = 800 m² (B369)
 - 100m x 4m = 400 m² (B370)
- Verplaatste weg (breedte 2 meter):
 - 100m x 2m = 200 m² (B369)
- Uitk. van de fozzebek:
 - 100m x 4m = 400 m² (B370)
- Uitk. van de spoorw. (Breedte 2 meter):
 - 100m x 2m = 200 m² (B370)
- 100m x 4m = 400 m² (B374)
- 100m x 4m = 400 m² (B375)
- 100m x 4m = 400 m² (B372)
- 100m x 4m = 400 m² (B373)
- 100m x 4m = 400 m² (B374)
- 100m x 4m = 400 m² (B375)
- 100m x 4m = 400 m² (B376)
- 100m x 4m = 400 m² (B377)
- 100m x 4m = 400 m² (B378)
- 100m x 4m = 400 m² (B379)
- 100m x 4m = 400 m² (B380)
- 100m x 4m = 400 m² (B381)
- 100m x 4m = 400 m² (B382)
- 100m x 4m = 400 m² (B383)
- 100m x 4m = 400 m² (B384)
- 100m x 4m = 400 m² (B385)
- 100m x 4m = 400 m² (B386)
- 100m x 4m = 400 m² (B387)
- 100m x 4m = 400 m² (B388)
- 100m x 4m = 400 m² (B389)
- 100m x 4m = 400 m² (B390)
- 100m x 4m = 400 m² (B391)
- 100m x 4m = 400 m² (B392)
- 100m x 4m = 400 m² (B393)
- 100m x 4m = 400 m² (B394)
- 100m x 4m = 400 m² (B395)
- 100m x 4m = 400 m² (B396)
- 100m x 4m = 400 m² (B397)
- 100m x 4m = 400 m² (B398)
- 100m x 4m = 400 m² (B399)
- 100m x 4m = 400 m² (B400)

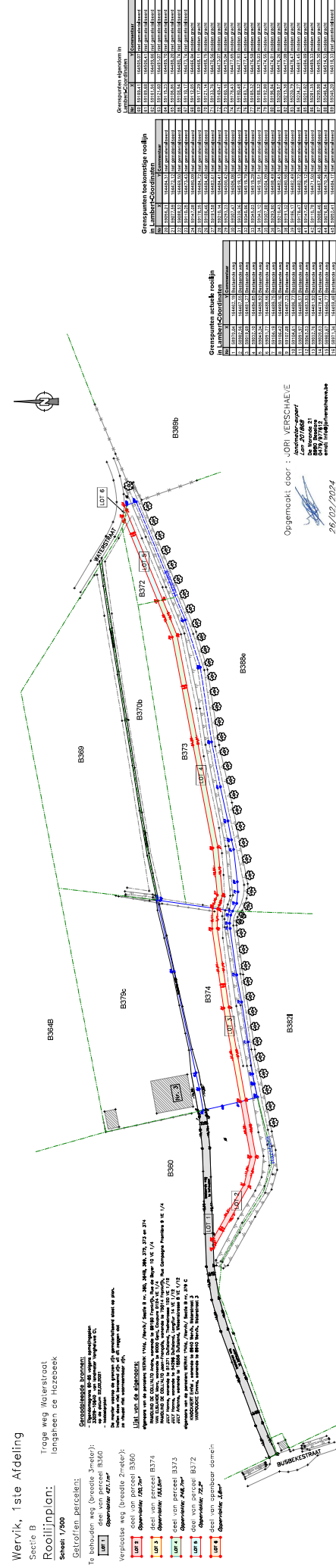

GRONDBEGRIEPEN: SCHEMELING
 - 100m x 4m = 400 m² (B360)
 - 200m x 4m = 800 m² (B369)
 - 100m x 4m = 400 m² (B370)

Verplaatste weg (breedte 2 meter):
 - 100m x 2m = 200 m² (B369)

Uitk. van de fozzebek:
 - 100m x 4m = 400 m² (B370)

Uitk. van de spoorw. (Breedte 2 meter):
 - 100m x 2m = 200 m² (B370)

100m x 4m = 400 m² (B374)

100m x 4m = 400 m² (B375)

100m x 4m = 400 m² (B372)

100m x 4m = 400 m² (B373)

100m x 4m = 400 m² (B374)

100m x 4m = 400 m² (B375)

100m x 4m = 400 m² (B376)

100m x 4m = 400 m² (B377)

100m x 4m = 400 m² (B378)

100m x 4m = 400 m² (B379)

100m x 4m = 400 m² (B380)

100m x 4m = 400 m² (B381)

100m x 4m = 400 m² (B382)

100m x 4m = 400 m² (B383)

100m x 4m = 400 m² (B384)

100m x 4m = 400 m² (B385)

100m x 4m = 400 m² (B386)

100m x 4m = 400 m² (B387)

100m x 4m = 400 m² (B388)

100m x 4m = 400 m² (B389)

100m x 4m = 400 m² (B390)

100m x 4m = 400 m² (B391)

100m x 4m = 400 m² (B392)

100m x 4m = 400 m² (B393)

100m x 4m = 400 m² (B394)

100m x 4m = 400 m² (B395)

100m x 4m = 400 m² (B396)

100m x 4m = 400 m² (B397)

100m x 4m = 400 m² (B398)

100m x 4m = 400 m² (B399)

100m x 4m = 400 m² (B400)

Compartimenten ingedeeld in

№	Compartiment	Oppervlakte (m ²)
1
2
3
4
5
6
7
8
9
10
11
12
13
14
15
16
17
18
19
20
21
22
23
24
25
26
27
28
29
30
31
32
33
34
35
36
37
38
39
40
41
42
43
44
45
46
47
48
49
50

Grenspunten loekbestemde rooilijn
in Lambert-Schmidlijnen

№	X	Y
1
2
3
4
5
6
7
8
9
10
11
12
13
14
15
16
17
18
19
20
21
22
23
24
25
26
27
28
29
30
31
32
33
34
35
36
37
38
39
40
41
42
43
44
45
46
47
48
49
50

Grenspunten oekbestemde rooilijn
in Lambert-Schmidlijnen

№	X	Y
1
2
3
4
5
6
7
8
9
10
11
12
13
14
15
16
17
18
19
20
21
22
23
24
25
26
27
28
29
30
31
32
33
34
35
36
37
38
39
40
41
42
43
44
45
46
47
48
49
50

Opgemaakt door: -ORI VERCHEA/E
 Aan 20/08/2024
 26/02/2024